

KÄRCHER

makes a difference

BR 35/12 C Bp

English

3

中文

15

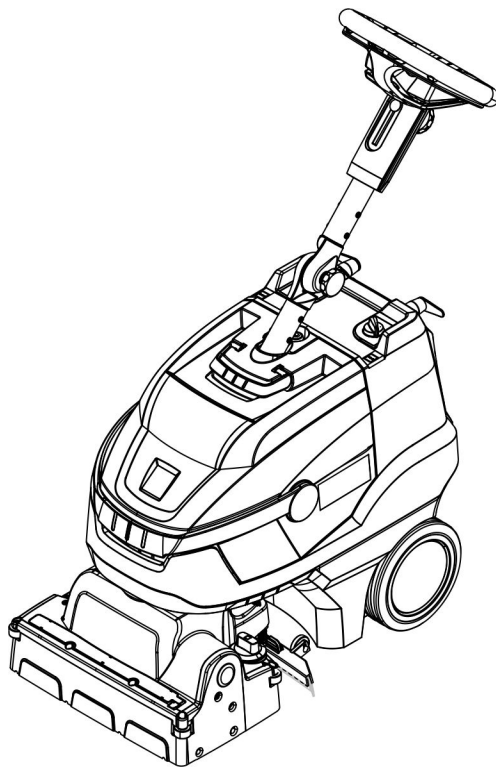

Register and win!
www.kärcher.com/register-and-win



59653220 04/17



Please read and comply with these original instructions prior to the initial operation of your appliance and store them for later use or subsequent owners.

Contents

Safety instructions	EN . . . 1
Function	EN . . . 2
Proper use	EN . . . 2
Environmental protection	EN . . . 2
Operating elements	EN . . . 3
Before Startup	EN . . . 4
Operation	EN . . . 4
Transport	EN . . . 6
Storage	EN . . . 7
Care and maintenance	EN . . . 7
Disposal	EN . . . 8
Faults	EN . . . 9
Accessories	EN . . 10
Technical specifications	EN . . 11
Warranty	EN . . 12
Spare parts	EN . . 12

Safety instructions

Before using the appliance for the first time, read and observe these operating instructions and the accompanying brochure: Safety information for brush cleaning units, 5.956-251.0.

⚠ WARNING

Do not use the appliance on inclines.

The appliance may only be operated when the container and all lids are closed.

Symbols in the operating instructions

⚠ DANGER

Immediate danger that can cause severe injury or even death.

⚠ WARNING

Possible hazardous situation that could lead to severe injury or even death.

CAUTION

Possible hazardous situation that could lead to mild injury to persons or damage to property.

Information on battery (accumulator) and charger

Lithium-ion batteries are installed in the appliance. These are subject to special criteria. The removal and the installation as well as the examination of defective batteries may only be performed by the Kärcher aftersales service or a specialist.

Information on storage and transport can be obtained from your Kärcher aftersales service.

⚠ DANGER

- *Alterations and modifications on the appliance are prohibited.*
- **Do not open the battery**, as there is a risk of an electrical shock; also, irritating or caustic vapors can escape.
- **Do not expose the battery to direct sunlight, heat or fire**, there is a risk of explosion.
- *Do not operate the charger in explosive environment.*
- *Ensure sufficient ventilation during the charging process.*
- *Do not use the charger if dirty or wet.*
- *Do not work with open flames, generate sparks or smoke in the vicinity of a battery or a battery charging room. Danger of explosion.*

⚠ WARNING

- *Check the appliance and the power cable for damage prior to every use. Do*

not use damaged appliances and have damaged parts repaired by specialists only.

- *Keep children away from batteries and charger.*
- *Do not charge damaged batteries. Have damaged batteries replaced by the Kärcher aftersales service.*
- *Do not discard defective batteries in the domestic waste, inform Kärcher aftersales service.*
- *Avoid contact with liquids oozing out of defective battery packs. Rinse thoroughly if you accidentally come in contact with the fluid. Also consult a doctor if the fluid comes in contact with your eyes.*

CAUTION

- *These operating instructions must be observed unconditionally. Observe recommendations of the lawmaker for handling batteries.*
- *The mains voltage must correspond with the voltage indicated on the type plate of the appliance.*
- *Use the charger only to charge approved battery packs.*
- *The accumulator may only be operated with this appliance. It is dangerous and prohibited to use it for other purposes.*

Safety installations

If the safety switch is released, the brush drive shuts off.

Function

The scrubbing vacuum cleaner is used for the wet cleaning of level floors.

It can be easily adjusted to the cleaning task by setting the water quantity.

A working width of 350 mm and a capacity of 12 l in the fresh and wastewater tank each enable effective cleaning with long action times.

The battery can be charged on a 230V power outlet by means of the integrated charger.

Proper use

Use this appliance only as directed in these operating instructions.

- The appliance should only be used for cleaning level floors that are not affected by moisture.
- This appliance is intended for inside use.
- The appliance is not suited for the cleaning of frozen grounds (e.g. in cold stores).
- The appliance may only be equipped with original accessories and spare parts.

Environmental protection



The packaging material can be recycled. Please do not place the packaging into the ordinary refuse for disposal, but arrange for the proper recycling.



Old appliances contain valuable materials that can be recycled. Please arrange for the proper recycling of old appliances. Please dispose your old appliances using appropriate collection systems.

Notes about the ingredients (REACH)

You will find current information about the ingredients at:

www.kaercher.com/REACH

Operating elements

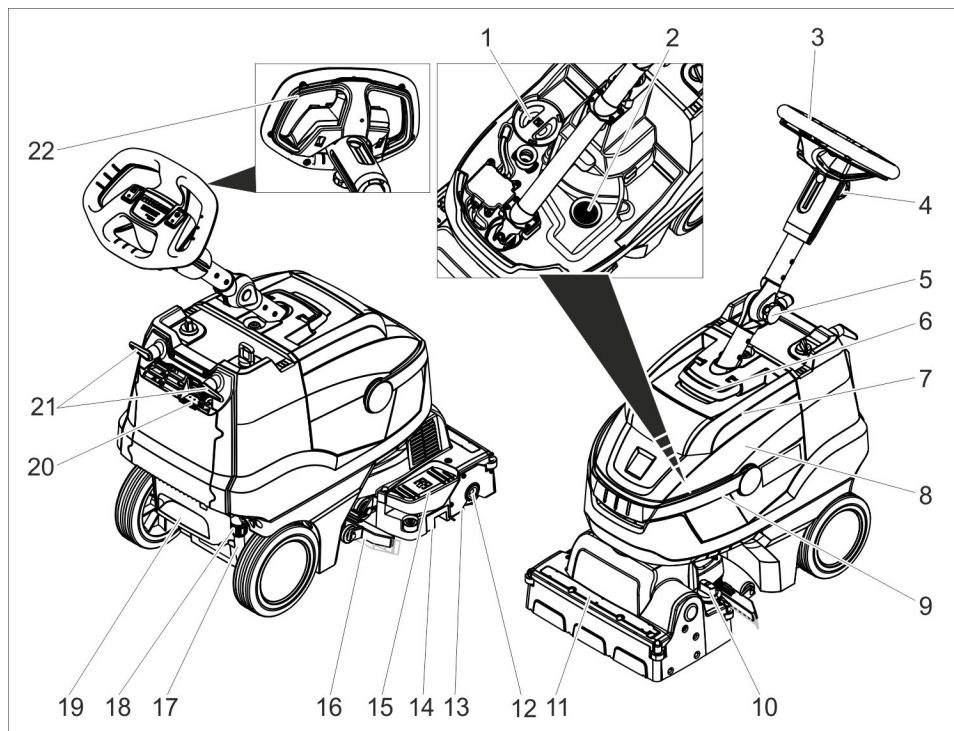

- | | |
|---|--|
| 1 Fresh water tank cover | 15 Vacuum bar lift pedal |
| 2 Fluff filter | 16 Vacuum bar |
| 3 Steering wheel | 17 Fresh water level display |
| 4 Star knob, height adjustment of the steering wheel | 18 Coupling for draining the fresh water |
| 5 Star knob, transport position of the steering wheel | 19 Step depression |
| 6 Unlocking device, cover waste water tank | 20 Battery charging display |
| 7 Cover dirt water reservoir | 21 Cable hook, rotating |
| 8 waste water tank | 22 Safety button |
| 9 Carrying handle for waste water tank | |
| 10 Rotating handle for brush contact pressure
(1=min, 4=max) | |
| 11 Water distribution bar | |
| 12 Unlocking button for brush roller | |
| 13 Brush roller | |
| 14 Coarse dirt container | |

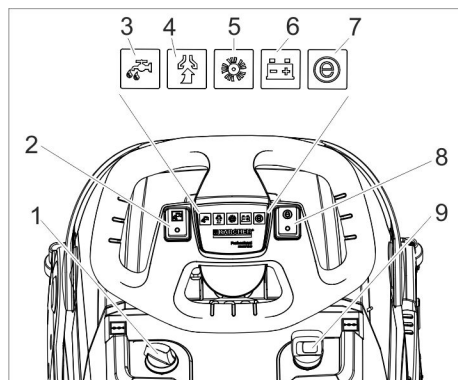

- 1 Dosage cleaning solution
- 2 Switch for detergent solution
- 3 Control lamp to apply detergent solution
- 4 Indicator lamp vacuuming
Green: Suction turbine in operation
Orange, flashing: Suction turbine overloaded
- 5 Indicator lamp brush drive
Green: Brush is rotating
Orange, flashing: Brush overloaded
- 6 Battery status display
Green Battery charged
Orange: Battery almost empty
Red Appliance switches off: Load battery
- 7 Indicator lamp Eco mode
- 8 Switch Eco mode
- 9 Power switch

Before Startup

Charging battery

NOTICE

The device is equipped with a safety mechanism to prevent total discharge, i.e. when the permissible minimum capacity is reached, the machine will be shut off. The charging process takes approx. 3 hours.

The charger automatically switches off the charging process.

If necessary, the appliance can be used again before the battery has been fully charged.

➔ Insert the mains plug into the socket.

Battery charging display

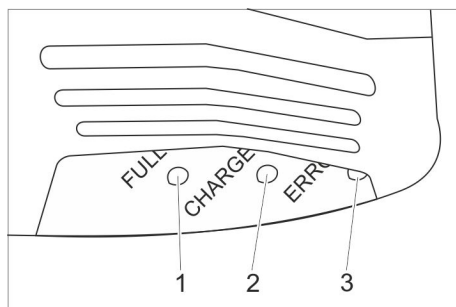

- 1 Battery is charged (green)
- 2 Battery is being charged (yellow, flashing)
- 3 Malfunction (red)

Operation

- ➔ Release the star knob for the transport position.
- ➔ Straighten the steering column.
- ➔ Tighten the star handle.

Filling in detergents

⚠ Warning

Risk of damage. Only use the recommended detergents. With respect to different detergents the operator bears the increased risk regarding the operational safety and danger of accident. Only use detergents that are free from solvents, hydrochloric acid and hydrofluoric acid.

Follow the safety instructions for using detergents.

Note

Do not use highly foaming detergents. Observe the dosing notes.

- ➔ Swivel up the carrying handle of the waste water tank.
- ➔ Lift out the waste water tank and put it aside.
- ➔ Remove the lid from the fresh water reservoir.
- ➔ Fill in fresh water (maximum 50 °C).
- ➔ Add detergent. Follow dosing instructions for detergent.

Recommended detergents:

Application	Detergent
Regular cleaning (even for floors sensitive to alkalis)	RM 745 RM 746
Cleaning dirt from grease	RM 69 ES ASF RM 69 ASF
Basic cleaning (strip- ping) of alkali-resistant hard coatings	RM 752
Basic cleaning (strip- ping) linoleum	RM 754
Base cleaner, acidic	RM 751
Disinfection cleaning	RM 732

Detergents are available in specialised stores.

- Close the cover of the fresh water reservoir.
- Place the waste water tank on the appliance.

Settings

- Release the star knob for the height adjustment of the steering wheel.
- Adjust the steering wheel to the desired height.
- Tighten the star handle.
- Adjust the dosing of the cleaning solution in accordance with the soiling and the type of the flooring material.
- Adjust the rotary handle of the brush contact pressure to the desired value.
Only adjust the brush contact pressure when the cleaning head is raised.

Note:

If the appliance pulls forwards too strongly during operation, reduce the contact pressure.

- Bring the Eco mode switch into the desired position.

Normal operation: The appliance works at the maximum brush speed and the highest suction performance.

Eco: The appliance works at reduced brush speed and suction performance. This also reduces the energy consumption. The possible action time with one charging cycle increases.

Cleaning

CAUTION

Risk of damage to the floor covering. Do not operate the appliance on the spot.

Risk of damage. Lift the vacuum bar before pulling the appliance backwards over a longer distance.

- Set the appliance switch to "I".
- Switch on "Detergent" button.
- Press the switch of the suction turbine; the vacuum process will start.
- Push down the pedal of the vacuum bar lifting device at the back to lower the vacuum bar.
- Pull the safety switch towards the steering wheel, the brush drive and the application of the cleaning solution are switched on (if preset).
- Push the appliance forward until the parking stand folds up and the cleaning head touches the ground.
- Move the appliance over the surface to be cleaned.

Note:

If the steering wheel is turned by 180°, the appliance also reverses.

Shutting Down the Appliance

- Release the safety switch.
- Drive the appliance forward for another 1-2 m to draw off residual water.
- Push down the pedal of the vacuum bar lifting device at the front to raise the vacuum bar.

CAUTION

Vacuum lips and brush can be deformed permanently. Always park the appliance with the parking stand folded out.

- Set the appliance switch to "0".
- Place one foot in the tread and lift the front of the appliance by pulling on the steering wheel until the parking stand folds out.

Emptying the waste Water tank

Warning

Please observe the local provisions regarding the wastewater treatment.

- Swivel the handle of the waste water tank up and let it snap into place.
- Remove the waste water tank.

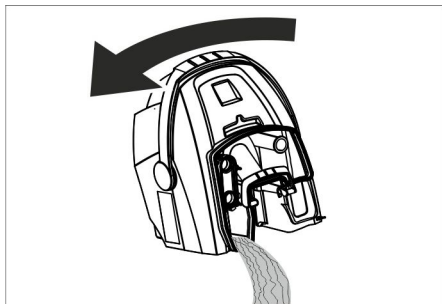

- Remove the cover of the waste water tank.
- Empty the waste water tank.
Swivel the waste water tank sideways during emptying so that the tank is completely drained.
- Rinse the dirt water reservoir with clear water.
- Reattach the waste water tank to the appliance.

Emptying the Fresh Water Tank

Warning

Please observe the local provisions regarding the wastewater treatment.

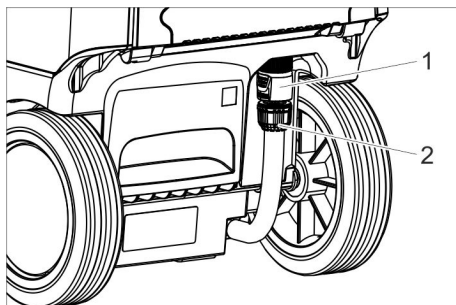

- 1 Coupling for draining the fresh water
- 2 Fresh water level display

- Slide the coupling down.
- Remove the hose of the level indicator and swivel it downwards.

Frost protection

In case of danger of frost:

- Empty the fresh and dirt water reservoirs.
- Store the appliance in a frost-protected room.

Folding down the steering column

To reduce the space requirements for transport and storage, the steering column can be folded down.

- Release the star knob for the transport position.
- Swivel the steering wheel forwards.
- Tighten the star handle.

Transport

CAUTION

Risk of injury and damage! Observe the weight of the appliance when you transport it.

- Remove the brush to avoid damage to the brushes.
- When transporting in vehicles, secure the appliance according to the guidelines from slipping and tipping over.

Storage

CAUTION

Risk of injury and damage! Note the weight of the appliance in case of storage.

This appliance must only be stored in interior rooms.

Care and maintenance

⚠ DANGER

Risk of injury. Turn the appliance switch to "0" and pull the mains plug of the charger prior to performing any work on the appliance.

CAUTION

Risk of damage for the appliance due to leaking water. Drain the wastewater and remaining fresh water prior to performing tasks on the appliance.

→ Park the machine on an even surface.

Maintenance schedule

After the work

⚠ Warning

Risk of damage. Do not wash down the appliance with water and do not use aggressive detergents.

- Drain off dirt water.
- Remove the lid of the waste water tank and wash the inside of the lid and the float with water.
- Rinse the waste water tank with clear water.
- Clean the vacuum bar.
- Remove bulk waste container and empty it.
- Clean the outside of the appliance with a damp cloth which has been soaked in mild detergent.
- Clean the vacuum lips, check for wear and replace them if required.
- Clean brush.
- Check the brush for wear and replace if required (see "Maintenance tasks").
- Charge battery if required.

Weekly

- Remove the water distribution bar on the cleaning head and clean the water channel.

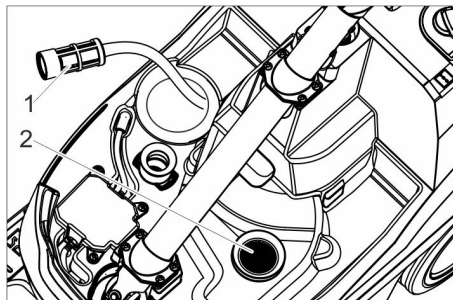

- 1 Fresh water filter
- 2 Fluff filter

- Clean the fresh water filter.
- Clean the fluff filter.

Monthly

- Check the condition of the seals between waste water tank and cover, replace if required.

Yearly

- Have the prescribed inspection carried out by the customer service.

Maintenance Works

Replacing the suction lips

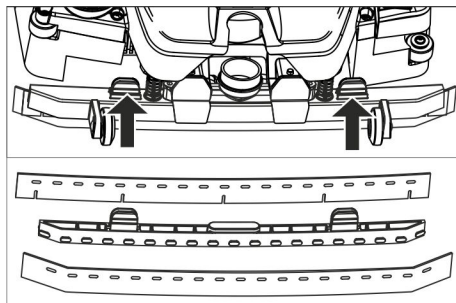

- Compress the fastening devices and pull the vacuum lips out of the vacuum bar towards the bottom.
- Remove the vacuum lips from the holder.

Note:

Thanks to the perforation pattern the vacuum lips cannot be mixed up. They cannot be turned and reinstalled.

- ➔ Replace vacuum lips.
- ➔ Insert the holder with the vacuum lips into the vacuum bar and snap into place.

Replacing the brush roller

⚠ WARNING

Risk of crushing due to the parking stand folding up during the brush replacement. Turn the steering wheel by 90° to the left prior to the brush replacement.

- ➔ Press the release button for the brush roller and swivel the brush roller toward the bottom and pull it off the driver.
- ➔ Place the new brush roller on the driver and lock into place on the opposite side.

Maintenance contract

To ensure a reliable operation of the appliance maintenance contracts can be concluded with the competent Kärcher sales office.

Disposal

Removing the battery

⚠ DANGER

The removal of the battery may only be performed by the Kärcher aftersales service or a specialist.

The evaluation, whether the battery is damaged or not, is done by an authorised aftersales technician

The Chapter "Safety instructions" for handling accumulators must be observed unconditionally.

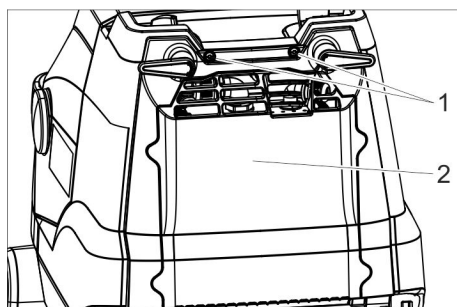

- 1 Screw
- 2 Cover

- ➔ Unscrew 2 screws.
- ➔ Swivel the lid downwards.
- ➔ Loosen and remove the battery plug.
- ➔ Remove the battery.
- ➔ Dispose of used battery in accordance with the applicable provisions.

Faults

DANGER

Risk of injury. Turn the appliance switch to "0" and pull the mains plug of the charger prior to performing any work on the appliance.

Warning

Risk of damage to the appliance on account of water leakage. Drain out dirty water and the remaining free water before working at the machine.

In case of faults that cannot be remedied using the table below please contact the customer service.

Fault	Remedy
Appliance cannot be started	Switch on the appliance switch, wait 3 seconds, check charge condition of the battery.
Insufficient water quantity	Check fresh water level, refill tank if necessary.
	Switch on "Detergent" button.
	Open the dosing device for the cleaning solution.
	Clean the fresh water filter.
Insufficient vacuum performance	Lower the vacuum bar.
	Empty the waste water tank.
	Clean the seals between waste water tank and cover and check for tightness, replace if required.
	Clean the vacuum lips on the vacuum bar, turn or replace if required
	Check if the suction hose and vacuum bar are chocked, clean if required
Insufficient cleaning result	Check/set the brush contact pressure.
	Check the brush type and the detergent for their suitability.
	Check the brushes for wear, replace if required.
Brush does not turn	Pull the safety switch towards the steering wheel.
	Check if foreign matters are blocking the brush roller; remove foreign matter if required.
	Switch off the switch for the brush drive, wait for a short period of time, switch the switch back on.

Accessories

The appliance can be equipped with various accessories depending on the cleaning task. Please request our catalogue or visit us on the Internet at www.kaercher.com.

Description	Part no.:	Description
Brush roller, white (soft)	4.037-036.0	For polishing floors.
Brush roller, red (medium, standard)	4.037-031.0	For cleaning slightly dirtied or sensitive floors.
Brush roller, green (hard)	4.037-038.0	For cleaning heavily dirtied floors.
Brush roller, black (very hard)	4.037-039.0	For cleaning heavily dirtied floors.
Brush roller, orange (high/low)	4.037-037.0	For scrubbing structured floors (safety tiles, etc.).
Microfibre roller	4.037-040.0	Cleaning brush made of microfibres with especially high cleaning performance, especially for fine stone tiles.
Pad roller shaft	4.762-009.0	For intake of roller pads.
Roller pad, red (medium)	6.369-047.0	For cleaning slightly dirtied floors.
Roller pad, green (hard)	6.369-052.0	For cleaning normal to heavily dirtied floors.
Roller pad, yellow (soft)	6.369-053.0	For polishing floors.
Fill hose	6.680-124.0	For filling the fresh water tank
Suction lip kit	4.037-035.0	As replacement

Technical specifications

Power		
Nominal voltage	V	25,2
Battery capacity	Ah (5h)	21
Battery type		Li-ion
Average power consumption	W	500
Protective class	-	1
Suction engine output	W	280
Brush engine output	W	185
Operating temperature range	°C	0...40
Vacuuming		
Cleaning power, air quantity	l/s	20
Cleaning power, negative pressure	kPa	8
Cleaning brushes		
Working width	mm	350
Brush diameter	mm	96
Brush speed	1/min	1050
Charger		
Voltage	V/Hz	220...240/50...60
Power Input	W	300
Dimensions and weights		
Theoretical surface cleaning performance	m²/h	1400
Fresh/waste water tank volume	l	12
Permissible overall weight	kg	48
Transport weight	kg	36
Length x width x height	mm	930x420x1100
Values determined as per EN 60335-2-72		
Total oscillation value	m/s²	<2,5
Uncertainty K	m/s²	0,2
Sound pressure level L_{pA}	dB(A)	65
Uncertainty K_{pA}	dB(A)	2
Sound power level L_{WA} + Uncertainty K_{WA}	dB(A)	84

Warranty

The warranty terms published by our competent sales company are applicable in each country. We will repair potential failures of your accessory within the warranty period free of charge, provided that such failure is caused by faulty material or defects in fabrication. In the event of a warranty claim please contact your dealer or the nearest authorized Customer Service center. Please submit the proof of purchase.

Spare parts

Only use original accessories and spare parts, they ensure the safe and trouble-free operation of the device.

For information about accessories and spare parts, please visit www.kaercher.com.



在您第一次使用您的设备前，请先阅读并遵守本操作说明书原件，为日后使用或其他所有者使用方便请妥善保管本说明书。

目录

目录	ZH . . 1
安全说明	ZH . . 1
功能	ZH . . 2
合乎规定的使用	ZH . . 2
环境保护	ZH . . 2
控制元件	ZH . . 3
设备运作前	ZH . . 4
设备运作	ZH . . 4
运输	ZH . . 6
储存	ZH . . 6
保养与维护	ZH . . 6
清理	ZH . . 7
故障	ZH . . 8
附件	ZH . . 9
产品规格 / 参数	ZH . 10
质量保证	ZH . 11
备件	ZH . 11

安全说明

请在首次使用本设备前阅读并注意本操作说明书及所附刷子清洁吸尘器和喷淋吸取式吸尘器安全提示手册 5.956-251.0。

⚠ 警告

不得在斜面上使用设备。

只有当桶和所有盖子都关闭时才允许使用本设备。

本操作说明书所用符号

⚠ 危险

即刻引发威胁的危险，致使身体严重伤害或死亡。

⚠ 警告

潜藏的危险情况，可能致使身体严重伤害或死亡。

小心

潜藏的危险情况，可能致使身体轻微伤害或损伤。

电池（蓄电池）和充电器提示

设备安装了锂离子电池。它必须符合特别标准。只允许 Kärcher 公司客户服务人员或专业人员对损坏的电池进行拆除、安装以及检查。

您可以从 Kärcher 公司客户服务人员处获得有关存放和运输方面的提示。

⚠ 危险

- 不允许在设备上改装和更改。
- **不要打开蓄电池**，存在短路的危险，另外有可能溢出难闻的蒸汽或者有腐蚀性的液体。
- **蓄电池不得承受强光辐射、受热及烘烤**，否则存在爆炸危险。
- 不得在存在爆炸危险的环境中使用充电器。
- 保持良好通风。
- 不得在脏污和潮湿的情况下使用充电器。
- 任何情况都不能在电池附近或在电池配电室内公然使用火焰、引起火花或抽烟。爆炸危险。

⚠ 警告

- 每次使用前，检查设备和电源线是否损坏。不再使用已损坏的设备，并只允许由专业人员维修损坏的零件。
- 让儿童远离电池和充电器。
- 不可对损坏的电池充电。由 Kärcher 公司客户服务人员更换已损坏的电池。
- 请不要把电池与生活垃圾放在一起处理，通知 Kärcher 公司客户服务人员。
- 避免与从损坏电池溢出的液体接触。意外接触液体时用水冲洗。与眼睛接触时还应立即就医。

小心

- 务必遵守本操作说明书。注意立法者关于处理电池的建议。
- 电源电压必须跟设备的型号标牌上给出的电压一致。
- 充电器只能用于为允许的蓄电池组充电。
- 只允许本设备操作蓄电池，禁止将它用于其他用途，将带来危险。

安全装置

如果放开安全开关，则刷子驱动器关闭。

功能

本磨边清洗机用于对平整地面进行湿式清洁。

它可通过调节水量轻松应对各种清洁任务。工作宽度 350 mm、净水箱和污水箱容量为 12 升，即便在使用时间较长的情况下仍能实现有效清洁。

电池可以通过安装的充电器，在一个 230-V 的插座上充电。

合乎规定的使用

请只根据本操作说明书中的说明使用本设备。

- 本设备只允许用于对湿度不敏感的光滑地面进行清洁。
- 本设备用于在室内使用。
- 本设备不适用于清洁冰冻地面（例如在冷冻房内）。
- 本设备只允许配置原配附件和备件。

环境保护



包装材料可以回收利用。请不要把包装材料与普通垃圾放在一起处理，而应妥善安排回收。



旧的设备中含有宝贵的可再利用的材料，应加以回收利用。请通过适当的收集系统处理您的旧设备。

内部材料提示 (REACH)

最新的内部材料信息请您在如下链接中查找：

www.kaercher.com/REACH

控制元件

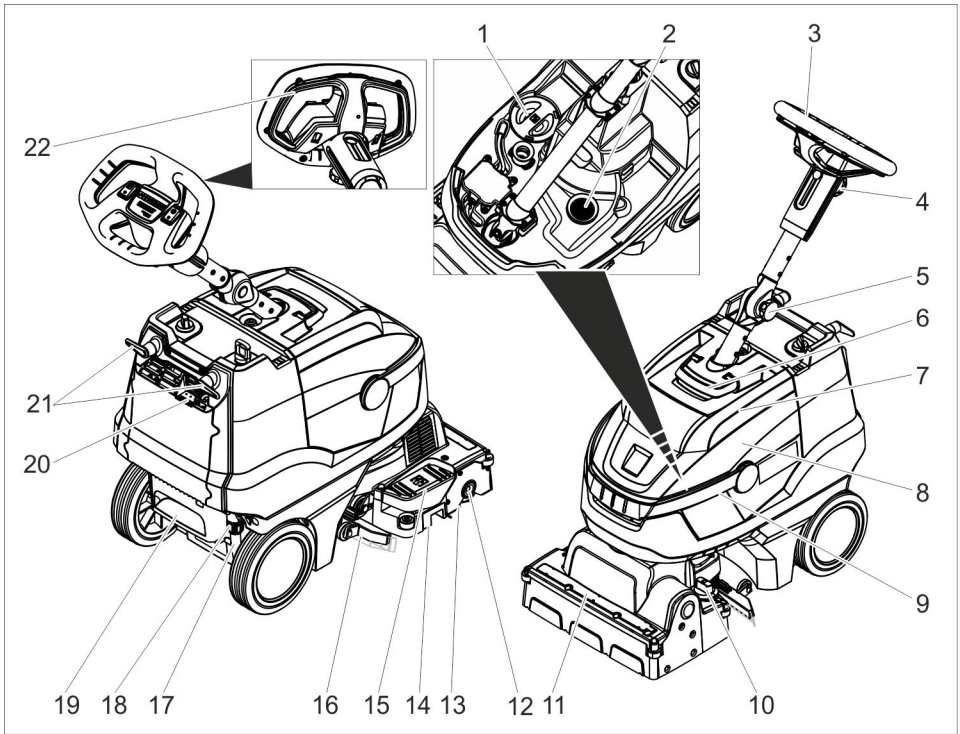

- | | |
|-------------------------------|--------------|
| 1 净水箱盖子 | 19 踏板槽 |
| 2 毛绒过滤器 | 20 电池充电显示 |
| 3 方向盘 | 21 可转动的电源线挂钩 |
| 4 星形柄，方向盘高度调节 | 22 安全开关 |
| 5 星形柄，方向盘运输位置 | |
| 6 解锁，污水箱盖子 | |
| 7 污水箱盖子 | |
| 8 污水箱 | |
| 9 污水箱手柄 | |
| 10 刷子压紧压力旋柄
(1= 最小, 4= 最大) | |
| 11 分水板 | |
| 12 刷子滚轴解锁按钮 | |
| 13 刷子滚轴 | |
| 14 大块脏物垃圾箱 | |
| 15 吸尘架升降脚踏 | |
| 16 吸尘架 | |
| 17 新水液位指示 | |
| 18 排出联轴器新水 | |

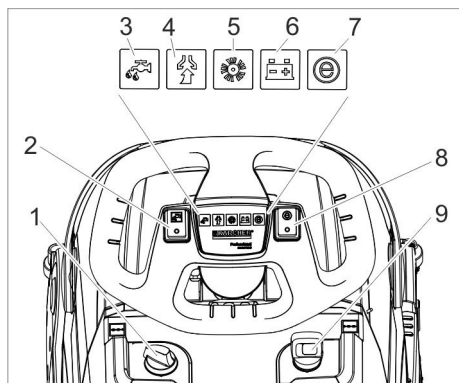

- 1 清洁液计量
- 2 清洁液开关
- 3 涂抹指示灯清洁液
- 4 吸入指示灯
绿色：吸尘涡轮机运行
橙色闪烁：吸尘涡轮机过载
- 5 刷子驱动器指示灯
绿色：刷子转动
橙色闪烁：刷子过载
- 6 电池状态显示
绿色：电池电量充满
橙色：电池接近用空
红色：设备关闭 —— 充电
- 7 节能模式指示灯
- 8 Eco Mode 开关
- 9 设备开关

设备运作前

电池充电

提示

本设备具有一个深放电保护装置，也就是说，如果达到了仍然允许的最低限度电量，则设备关闭。

充电时间约为 3 小时。

充电器自行结束充电过程。

在电池完全充满电前，需要时也可再次使用设备。

➔ 插上电源插头。

电池充电显示

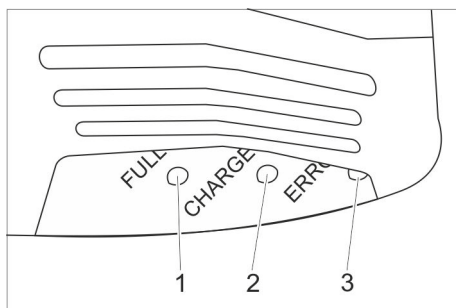

- 1 电池电量充满（绿色）
- 2 电池充电中（黄色闪烁）
- 3 故障（红色）

设备运作

- ➔ 松开运输位置星形柄。
- ➔ 对齐转向柱。
- ➔ 拧紧星形柄。

加入工作材料

⚠ 警告

设备损坏危险。只使用推荐的清洁剂。如使用其它清洁剂，设备所有人在工作安全和事故危险方面将承担更高的风险。只使用不含溶剂、盐酸和氢氟酸的清洁剂。注意关于洗涤剂的安全提示。

提示

不要使用产生大量泡沫的清洁剂。注意计量提示。

- ➔ 向上转动污水箱手柄
- ➔ 抬起污水箱并置于一边。
- ➔ 取下净水箱盖子。
- ➔ 加入新水（最高温度为 50 °C）。
- ➔ 掺加清洁剂。注意计量提示。

推荐的清洁剂：

应用	清洁剂
家用清洁 （也使用在对碱敏感的地面上）	RM 745 RM 746
清洁油脂污物	RM 69 ES ASF RM 69 ASF

初步清洁（带状）耐碱性硬质地板	RM 752
初步清洁油毡（带状）	RM 754
地面清洁剂，酸性	RM 751
消毒型清洁剂	RM 732

清洁剂可在专业商店买到。

- ➔ 关上净水箱的盖子。
- ➔ 将污水箱装入设备。

调整

- ➔ 松开方向盘上用于调节高度的星形柄。
- ➔ 把方向盘调到所需高度。
- ➔ 拧紧星形柄。
- ➔ 根据地板污染程度和地板类型调节清洁液计量。
- ➔ 将刷子压紧压力旋柄调节到所需数值。只能在清洁头提起时，调节刷子压紧压力。

提示：

如果在运行中设备向前拉出过多，则压紧压力降低。

- ➔ 将 Eco Mode 开关调整至所需位置。

正常运行：设备以最大刷子转速和最高抽吸功率工作。

Eco：设备以降低的刷子转速和抽吸功率工作。同时能量消耗也减少。电池充满时的持续使用时间延长。

清洁

小心

有损坏地面铺层的危险。不在此地点使用本设备。

存在损坏危险。将设备向后拉长距离之前，提升吸尘架。

- ➔ 设备开关调到 “I”。
- ➔ 打开清洁液开关。
- ➔ 打开启动抽吸的抽吸涡轮机开关。
- ➔ 为降下吸尘架，将吸尘架升降脚踏向后往下压。
- ➔ 拔出方向盘的安全开关，刷子驱动器和清洁液任务启动（如有设置）。
- ➔ 向前推动设备，直至停放支座翻回且清洁头接触地面。
- ➔ 在需要清洁的面上行驶设备。

提示：

如果方向盘旋转了 180°，设备也向后行驶。

停顿和停放

- ➔ 松开安全开关。
- ➔ 设备还可向前行走 1-2 米，以便吸除残余的水。
- ➔ 为抬升吸尘架，将吸尘架升降脚踏向前往下压。

小心

吸嘴和刷子能够不断改变形状。总是将设备的停放支座翻开置放。

- ➔ 设备开关调到 “0”。
- ➔ 将踏板放到踏板槽内，并通过拉动方向盘向前抬升设备，直至停放支座翻开。

将污水箱排空

⚠ 警告

注意当地废水处理规范。

- ➔ 向上翻转污水箱手柄并使其卡入。
- ➔ 取下污水箱。

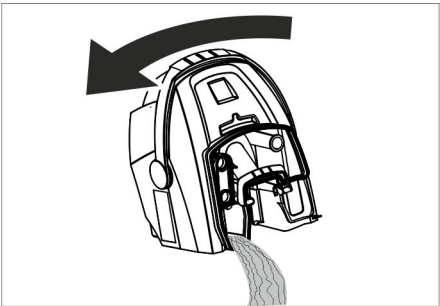

- ➔ 取下污水箱盖子。
 - ➔ 将污水箱排空。
- 在排空时，将污水箱向侧面翻转，以便完全排空箱子。
- ➔ 接着用清水冲洗污水箱。
 - ➔ 将污水箱重新装回设备。

将净水箱排空

⚠ 警告

注意当地废水处理规范。

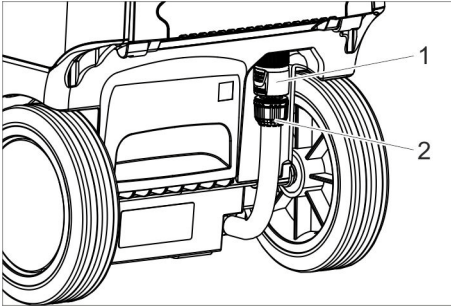

- 1 排出联轴器新水
- 2 新水液位指示

- ➔ 向下推动联轴器。
- ➔ 拔下液位指示软管并向后翻转。

防冻措施

如存在霜冻危险：

- ➔ 将净水箱和污水箱排空。
- ➔ 将设备停放在防霜冻的房间内。

移置转向柱

在运输和存放时，为了减小空间需求，可以移置转向柱。

- ➔ 松开运输位置星形柄。
- ➔ 将方向盘完全向前翻转。
- ➔ 拧紧星形柄。

运输

小心

受伤和损坏危险！ 运输时要注意设备的重量。

- ➔ 取出刷子，以免损坏刷子。
- ➔ 用车辆进行运输时，根据各适用准则确保设备不会滑倒和倾覆。

储存

小心

受伤和损坏危险！ 存放时要注意设备的重量。

该设备只能存放在室内。

保养与维护

⚠ 危险

受伤危险。 在设备上进行所有工作前，将设备开关旋转至“0”并拔下充电器的电源插头。

小心

一旦水流出，即产生损坏设备的危险。在设备上工作前排出污水和剩余的新水。

- ➔ 设备置放在平坦地面上。

保养计划

在工作结束后

⚠ 警告

设备损坏危险。 不要对设备喷水并且不要使用有侵蚀性的清洁剂。

- ➔ 排出污水。
- ➔ 取下污水箱的盖子并用水冲洗盖子内侧和浮球。
- ➔ 接着用清水冲洗污水箱。
- ➔ 清洁吸尘架。
- ➔ 取下并排空大块脏物垃圾箱。
- ➔ 使用浸泡过柔和性洗衣肥皂水的湿抹布清洁设备外部。
- ➔ 清洁吸嘴，检查是否磨损，如有需要，即行更换。
- ➔ 清洁刷子。
- ➔ 检查刷子是否磨损，如有需要，即行更换（参见“保养工作”）。
- ➔ 如有需要，即给电池充电。

每周的

- ➔ 取下清洁头上的分水板并清洁水槽。

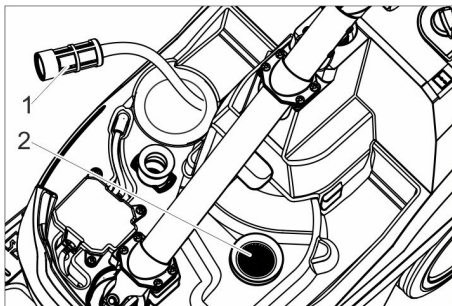

- 1 新水过滤器
- 2 毛绒过滤器

- ➔ 清洁新水过滤器。
- ➔ 清洗细滤网。

每月保养

- ➔ 检查污水箱与盖子之间的密封件的状态，如有需要，即行更换。

每年

- ➔ 让客户服务部门进行规定的检查。

保养工作

更换吸嘴

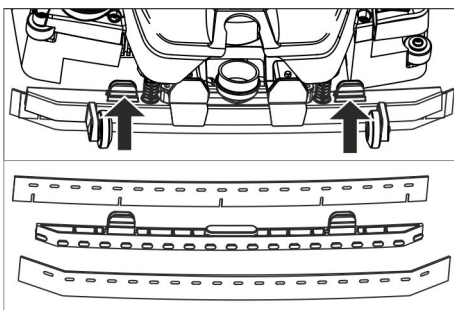

- ➔ 压紧固定元件并将吸嘴向下从吸尘架中拉出。
- ➔ 从支架上拔下吸嘴。

提示：

吸嘴通过孔模防止替换。无法进行转动或重新装入。

- ➔ 替换吸嘴。
- ➔ 将支架带吸嘴装入积尘架中并使其卡入。

更换刷辊

⚠ 警告

更换刷子期间，因停放支座翻回而产生挤压危险。更换刷子前，将方向盘向左打入 90°。

- ➔ 按下刷辊解锁按钮，将刷辊向下翻转并从夹持器上拔下。
- ➔ 将新的刷辊插到夹持器上并使其卡入背面。

保养合同

为了保障设备可靠运行，可与 Kärcher 公司主管销售处签订保养合同。

清理

拆卸电池

⚠ 危险

只允许 Kärcher 公司客户服务人员或专业人员进行电池拆除。

只能由已授权的客户服务装配人员对电池是否损坏进行评级。

处理蓄电池时，务必遵守章节“安全提示”。

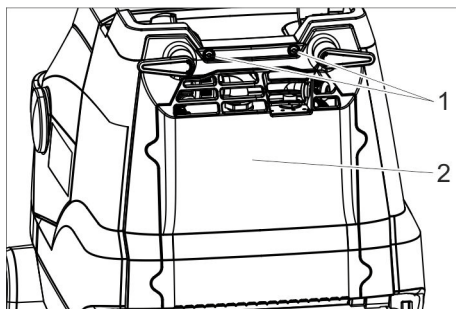

- 1 螺丝
- 2 顶盖

- ➔ 旋下 2 枚螺丝。
- ➔ 向下翻转盖子。
- ➔ 松开并拔下电池插头。
- ➔ 取出电池。
- ➔ 根据所适用的规定清理废旧电池。

故障

⚠ 危险

受伤危险。在设备上进行所有工作前，将设备开关旋转至“0”并拨下充电器的电源插头。

⚠ 警告

一旦水流出，即产生损坏设备的危险在设备上工作前排出污水和剩余的新水。一旦发生通过本表不能排除的故障，即电告客户服务处。

故障	排除故障
不可以启动设备	打开设备开关，等待 3 秒钟，检查电池充电状态。
水量不够	检查新水水位，如有需要，即给水箱加水。
	打开清洁液开关。
	打开清洁液计量。
	清洁新水过滤器。
抽吸功率不够	降下吸尘架。
	清空污水箱。
	清洁污水箱与盖子之间的密封件的状态并检查是否密封，如有需要，即行更换。
	清洁吸尘架上的吸嘴，如有需要，即行翻转或更换。
	检查抽吸软管和吸尘架是否堵塞，如有需要，即排除堵塞
	检查抽吸软管是否密封，如有需要，即行更换。
清洁效果不够	检查 / 调整刷子压紧压力。
	检查刷子型号和洗涤剂是否适用。
	检查刷子是否磨损，如有需要，即行更换。
刷子不转动	拉出方向盘的安全开关。
	检查刷辊是否被异物卡住，必要时去除异物。 关闭刷子驱动器开关，稍等之后重新打开开关。

附件

根据每次清洁任务，设备可配置不同的附件。请查阅我们的附件目录或访问我们的网站 www.kaercher.com。

名称	零件号	描述
刷辊，白色（软质）	4.037-036.0	用于打磨地面。
刷辊，红色（中等，标准）	4.037-031.0	用于清洁污染小或敏感性地面。
刷辊，绿色（硬质）	4.037-038.0	用于清洁严重污染的地面。
刷辊，黑色（很硬）	4.037-039.0	用于清洁严重污染的地面。
刷辊，橙色（高 / 深型）	4.037-037.0	用于刷净纹理地板（安全瓷砖等）。
微纤维辊	4.037-040.0	专门用于炆质砖，清洗刷采用微纤维制成，具有特别好的清洁效果。
底垫辊轴	4.762-009.0	用于装夹辊子底垫。
辊子底垫，红色（中等）	6.369-047.0	用于清洁轻微污染的地面。
辊子底垫，绿色（硬质）	6.369-052.0	用于清洁正常污染至严重污染的地面。
辊子底垫，黄色（软质）	6.369-053.0	用于打磨地面。
加水软管	6.680-124.0	用于净水箱的注水
吸嘴套件	4.037-035.0	作为备件

产品规格 / 参数

功率		
额定电压	伏	25, 2
电池容量	Ah (5 小时)	21
电池型号		锂离子
平均消耗功率	瓦	500
保护等级	-	1
吸尘电机功率	瓦	280
刷子电机功率	瓦	185
使用的温度范围	° C	0... 40
抽吸		
抽吸功率, 空气量	升 / 秒	20
抽吸功率, 负压	千帕斯卡	8
清洁刷子		
工作宽度	mm	350
刷子直径	mm	96
刷子转速	1/ 分钟	1050
充电器		
电压	V/Hz	220... 240/50... 60
消耗功率	瓦	300
尺寸和重量		
理论上的清洁面积效率	m²/h	1400
净水箱 / 污水箱容量	l	12
允许的总重量	千克	48
运输重量	千克	36
长度 x 宽度 x 高度	mm	930x420x1100
根据 EN 60335-2-72 确定的数值		
总振动值	m/s²	<2, 5
不确定度 K	m/s²	0, 2
声压等级 L _{pA}	A 级分贝	65
不安全性 K _{pA}	A 级分贝	2
声功率电平 L _{WA} + 不安全性 K _{WA}	A 级分贝	84

质量保证

我们的主管销售公司所发布的质量保证条件每个国家均适用。在质量保证期内，您的附件一旦发生意外故障，只要是材料或制造缺陷，我们都将免费排除。如属质量保证情况，请凭发票联系贵方经销商或就近联系获得授权的客户服务点。

备件

只使用原厂配件和备件，它们能保证设备的安全和无故障运行。

有关配件和备件的信息请登录

www.kaercher.com。



<http://www.kaercher.com/dealersearch>

